

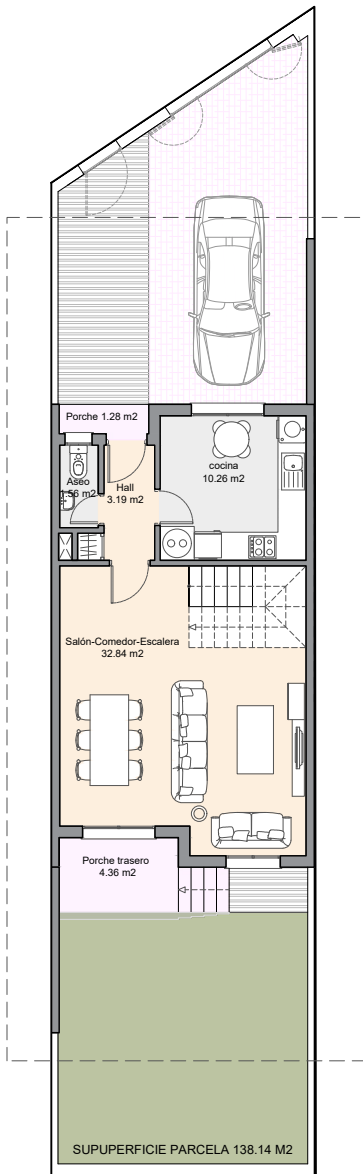

VIVIENDA 6 3 DORMITORIOS

SUPERFICIE CONSTRUIDA	116.95m ²
SUPERFICIE DE PARCELA	138.14m ²
SUP. UTIL S/D BOJA 218/8/2005	110.71m ²
SUP. CONSTRUIDA S/D BOJA 218/8/2005	126.11m ²



PARCELA

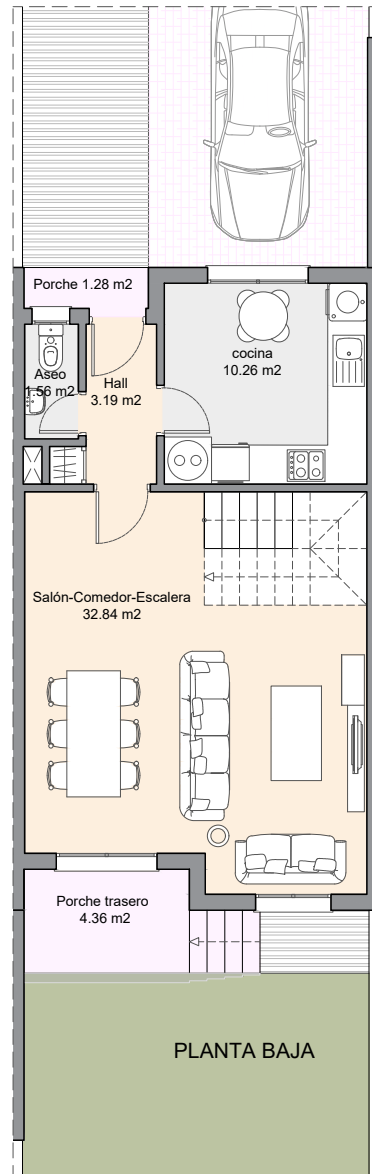

PLANTA BAJA

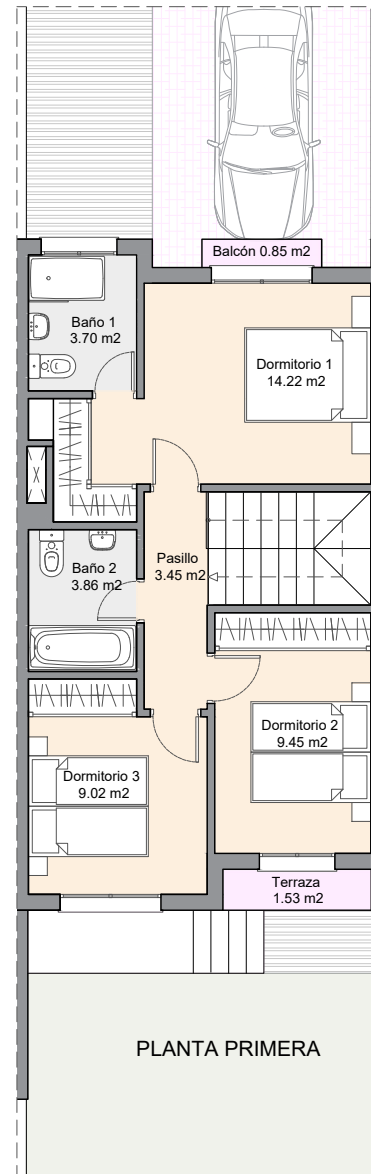

PLANTA PRIMERA

